

## SC SILENCIADOR CONICO

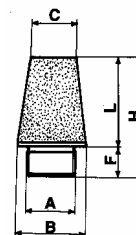

CODIGO	A	B	C	F	L	H	G	CH	CH1	Gr
SC M3	M3	-	-	-	-	-				
SC M5	M5	6	5	4,5	8,5	13				
SC 1/8	1/8	12	8	6	15	21				
SC 1/8 F	1/8 F	12	8	6	15	23				
SC 1/4	1/4	15	11	6	19	25				
SC 3/8	3/8	19	15	8	28	36				
SC 1/2	1/2	23	18	10	33	43				
SC 3/4	3/4	30	23	13	40	53				
SC 1	1"	38	28	15	48	63				



## SCQ SILENCIADOR CONICO CUADRADO



CODIGO	A	B	H	F	L	H	G	CH	CH1	Gr
SCQ M5	M5	12	7	6	15	21				
SCQ 1/8	1/8	12	7	6	15	21				
SCQ 1/8 F	1/8 F	17	7	6	15	23				
SCQ 1/4	1/4	15	8	6	19	25				
SCQ 3/8	3/8	19	10	8	28	36				
SCQ 1/2	1/2	23	14	10	33	43				
SCQ 3/4	3/4	30	16	13	40	53				
SCQ 1	1	38	20	15	48	63				

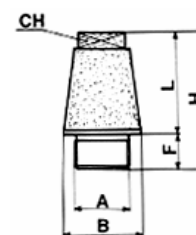

## SCT SILENCIADOR CONICO CON CORTE



CODIGO	A	B	C	F	L	H	G	CH	CH1	Gr
SCT M5	M5	6	5	4,5	8,5	13				
SCT 1/8	1/8	12	8	6	15	21				
SCT 1/8 F	1/8 F	12	8	6	15	21				
SCT 1/4	1/4	15	11	6	19	25				
SCT 3/8	3/8	19	15	8	28	36				
SCT 1/2	1/2	23	18	10	33	43				
SCT 3/4	3/4	30	23	13	40	53				
SCT 1	1	38	28	15	48	63				

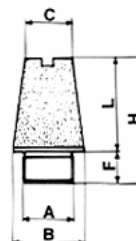

## SEP SILENCIADOR HEXAGONAL PLANO



CODIGO	A	B	C	F	L	H	G	CH	CH1	Gr
SEP M5	M5	6,5	8	3,5	3	8				
SEP 1/8	1/8	11	13	6	4	13				
SEP 1/8 F	1/8 F	11	13	6	4	13				
SEP 1/4	1/4	14	16	8	4	16				
SEP 3/8	3/8	17	19	9	4	18				
SEP 1/2	1/2	22	24	11	4	20				
SEP 3/4	3/4	28	30	13	4	24				
SEP 1"	1"	34	36	15	4	27				
SEP 1 1/4"	1"1/4	-	-	-	-	-				
SEP 1 1/2"	1"1/2	-	-	-	-	-				
SEP 2"	2"	-	-	-	-	-				

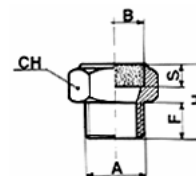

## SEC SILENCIADOR HEXAGONAL ESFERICO



CODIGO	A	B	S	F	H	F	G	CH	CH1	Gr
SEC M5	M5	6,5	3	3,5	8			8		
SEC 1/8	1/8	11	4	6	16			13		
SEC 1/8 F	1/8 F	12	4	6	20			14		
SEC 1/4	1/4	14	4	8	19			14		
SEC 3/8	3/8	17	4	9	21			19		
SEC 1/2	1/2	22	4	11	23			22		
SEC 3/4	3/4	28	4	13	27			30		
SEC 1	1"	34	4	15	29			36		
SEC 1 1/4	1"1/4	-	-	-	-			-		
SEC 1 1/2	1"1/2	-	-	-	-			-		
SEC 2	2"	-	-	-	-			-		

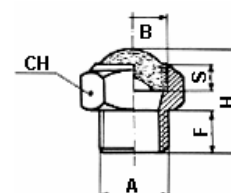

## SEM SILENCIADOR HEXAGONAL MEDIO



CODIGO	A	B	F	L	H	F	G	CH	CH1	Gr
SEM M5	M5	5	4	8	15			8		
SEM 1/8	1/8	8	6	8,5	20			13		
SEM 1/8 F	1/8 F	8	6	8,5	20			13		
SEM 1/4	1/4	11	8	10	25			16		
SEM 3/8	3/8	13,5	9	12	29			13,5		
SEM 1/2	1/2	17	11	15	35			24		
SEM 3/4	3/4	22	13	15,5	39			30		
SEM 1	1"	29	15	18	45			36		
SEM 1 1/4	1"1/4	-	-	-	-			-		
SEM 1 1/2	1"1/2	-	-	-	-			-		
SEM 2	2"	-	-	-	-			-		

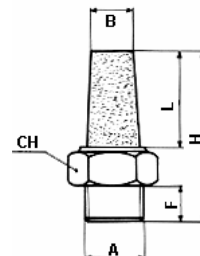

## SE SILENCIADOR HEXAGONAL



CODIGO	A	B	F	L	H	F	G	CH	CH1	Gr
SE M5	M5	4,5	3,5	-	17			7		
SE 1/8	1/8	8,5	4,5	-	21			12		
SE 1/8 F	1/8 F	7	6	16	29			13		
SE 1/4	1/4	11	6	-	27			15		
SE 3/8	3/8	14	7	-	35			19		
SE 1/2	1/2	17	8	-	40,5			23		
SE 3/4	3/4	22	9	-	51,5			30		
SE 1	1	26,5	11	-	66			36		
SE 1 1/4	1 1/4									
SE 1 1/2	1 1/2									
SE 2	2									

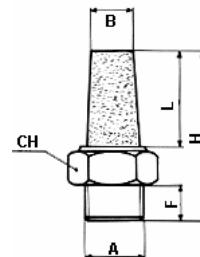

## SEA SILENCIADOR HEXAGONAL ALTO



CODIGO	A	B	F	L	H	F	G	CH	CH1	Gr
SEA M5	M5	4	8	18	3,5			8		
SEA 1/8	1/8	7	6	30	43			13		
SEA 1/8 F	1/8 F	7	6	30	13			13		
SEA 1/4	1/4	9	8	35	51			16		
SEA 3/8	3/8	10	9	39	56			10		
SEA 1/2	1/2	13	11	49	68			24		
SEA 3/4	3/4	17	13	46	70			30		
SEA 1	1	23	15	56	82			36		
SEA 1 1/4	1 1/4									
SEA 1 1/2	1 1/2									
SEA 2	2									

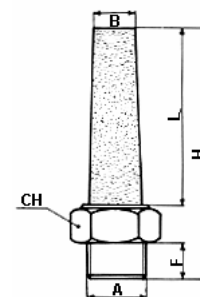

## SEJ SILENCIADOR HEXAGONAL CON ROSCA CONICA



CODIGO	A	B	F	L	H	F	G	CH	CH1	Gr
SEJ 1/8	1/8	7	6	16	29			13		
SEJ 1/4	1/4	9	8	35	51			16		
SEJ 3/8	3/8	17	9	40	57			17		
SEJ 1/2	1/2	17	11	48	67			27		
SEJ 3/4	3/4	26	14	68	90			36		
SEJ 1	1	34	17	79	106			50		

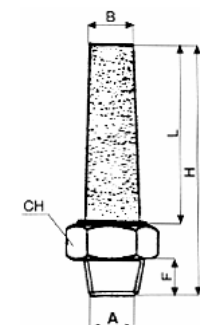

## SPB SILENCIADOR DE PLASTICO CON BRONCE



CODIGO	A	B	C	F	L	H	G	CH	CH1	Gr
SPB 1/8	1/8	7	15,5	7,5	13,5	30				
SPB 1/4	1/4	9	18	9	17	36				
SPB 3/8	3/8	13	22	11	24	48				
SPB 1/2	1/2	16	28	12	31,5	58				
SPB 3/4	3/4	20	34,5	15	27,5	60				
SPB 1	1	25	42,5	15	35,5	70				

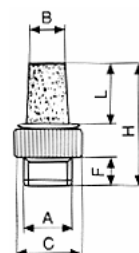

## SOS SILENCIADOR CON ORIENTADOR DE ESCAPE



CODIGO	A	B	L	H	E	F	G	CH	CH1	Gr
SOS 1/8	1/8	19,5	29	37						
SOS 1/4	1/4	23,5	33	45						
SOS 3/8	3/8	26,5	41	53						
SOS 1/2	1/2	33,5	51	65						
SOS 3/4	3/4	40	47	63						
SOS 1	1	48	60	78						

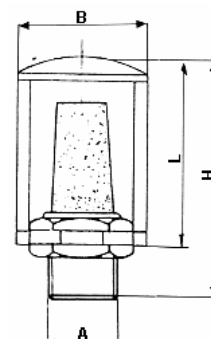

## ST SILENCIADOR REDONDO



CODIGO	A	B	F	L	H	F	G	CH	CH1	Gr
ST 1/8	1/8	10	6	6	12					
ST 1/4	1/4	13	6	6	12					
ST 3/8	3/8	17	7	8	15					
ST 1/2	1/2	21	10	8	18					
ST 3/4	3/4	26	13	9	22					
ST 1	1	33	14	11	25					

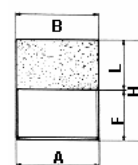

## STT SILENCIADOR REDONDO CON CORTE



CODIGO	A	B	C	P	F	L	H	CH	CH1	Gr
STT 1/8	1/8	10	1,5	2	6	6	12			
STT 1/4	1/4	13	1,5	2	6	6	12			
STT 3/8	3/8	17	1,5	2	7	8	15			
STT 1/2	1/2	21	1,5	2	10	8	18			
STT 3/4	3/4	26	1,5	2	13	9	22			
STT 1	1	33	1,5	2	14	11	25			

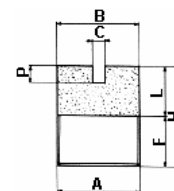

## SFE SILENCIADOR CON HILO AC.INOX. HEXAGONAL



CODIGO	A	B	S	F	H	F	G	CH	CH1	Gr
SFE M5	M5	6,5	3	3,5	8			8		
SFE 1/8	1/8	11	4	6	16			13		
SFE 1/8 F	1/8 F	12	4	6	20			14		
SFE 1/4	1/4	14	4	8	19			16		
SFE 3/8	3/8	-	9	-	21			19		
SFE 1/2	1/2	-	10	-	23			24		
SFE 3/4	3/4	28	4	10	27			30		
SFE 1	1	34	4	15	29			36		

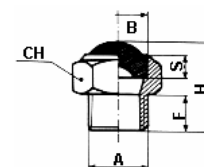

## SFEX SILENCIADOR DE ACERO INOXIDABLE



CODIGO	A	B	S	F	H	F	G	CH	CH1	Gr
SFEX M5	M5	6,5	3	3,5	8			6,5		
SFEX 1/8	1/8	11	4	6	16			13		
SFEX 1/8 F	1/8 F	-	-	-	-			-		
SFEX 1/4	1/4	14	4	8	19			16		
SFEX 3/8	3/8	17	4	9	21			19		
SFEX 1/2	1/2	22	4	10	23			24		
SFEX 3/4	3/4	28	4	10	27			30		
SFEX 1	1	34	4	15	29			36		

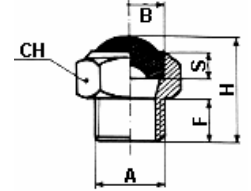

## SI SILENCIADOR DE ESCAPE MEJORADO



CODIGO	A	B	C	F	L	H	G	CH	CH1	Gr
SI 1/8	1/8	24	58	9	16	25				
SI 1/4	1/4	24	58	9	16	25				

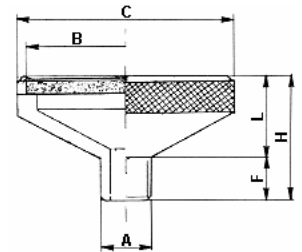

## SPL SILENCIADOR DE PLASTICO DINAMICO



CODIGO	A	B	F	L	H	F	G	CH	CH1	Gr
SPL 1/8	1/8	15	6	26,5	32,5					
SPL 1/8 F	1/8 F	15	6	26,5	32,5					
SPL 1/4	1/4	19,5	8	35	43					
SPL 3/8	3/8	24,5	11	47	58					
SPL 1/2	1/2	24,5	11	47	58					
SPL 3/4	3/4	48	18	97	115					
SPL 1	1	48	18	97	115					

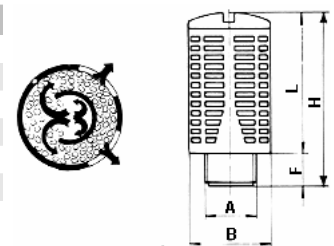

## SPL-F SILENCIADOR DE PLASTICO ESTATICO



CODIGO	A	B	F	D	H	C	G	CH	CH1	Gr
SPL-F 1/8	1/8	15,5	6	24,5	33	2,5		10		
SPL-F 1/8 F	1/8 F	15,5	6	24,5	33	2,5		10		
SPL-F 1/4	1/4	19,5	8	12	32	3		12		
SPL-F 3/8	3/8	24,5	11	44	58	3		16		
SPL-F 1/2	1/2	24,5	11	44	58	3		16		
SPL-F 3/4	3/4	50	18	90	118	10		25		
SPL-F 1	1	50	18	90	118	10		25		

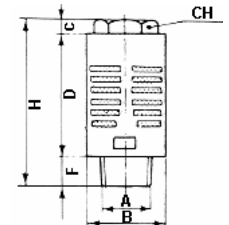

## SF SILENCIADOR REDONDO TIPO ALTO



CODIGO	A	B	L	H	E	F	G	CH	CH1	Gr
SF M5	M5	8	16	21						
SF 1/8	1/8	13	32	38						
SF 1/4	1/4	16	45	51						

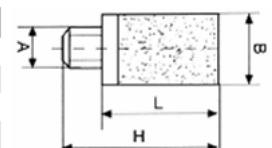

## SFI SILENCIADOR PARA TUBO



CODIGO	A	B	L	H	E	F	G	CH	CH1	Gr
SFI 35	35	8	16	21						
SFI 50	50	8	16	21						

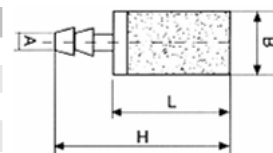

## SR SILENCIADOR DE ENCHUFE RAPIDO



CODIGO	Ø	A	B	S	F	L	H	CH	CH1	Gr
SR 4	4	5	7	3	28	10	38			
SR 5	5	5	7	3	32	10	42			
SR 6	6	6	8	3	34	10	44			
SR 8	8	8	10	4	34	14	44			
SR 10	10	10	12	4	36	14	50			
SR 12	12	11	14	4	44	16	60			
SR 14	14	14	16	4	46	19	65			

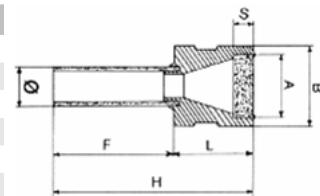

## SL SILENCIADOR TIPO MAXI



CODIGO	A	B	F	L	H	F	G	CH	CH1	Gr
SL 1/8	1/8	16	6	60	70			16		
SL 1/4	1/4	16	6	60	70			16		
SL 3/8	3/8	24	11	90	105			24		
SL 1/2	1/2	24	11	90	105			24		
SL 3/4	3/4	48	12	190	225			50		
SL 1	1	48	12	190	225			50		
SL 1 1/4	1"1/4	48	15	190	228			50		
SL 1 1/2	1"1/2	48	15	190	228			50		
SL 2	2"	48	17	190	230			65		

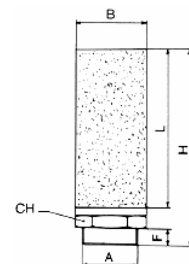

## SS SILENCIADOR INTERNO



CODIGO	A	B	C	H1	H	F	G	CH	CH1	Gr
SS 1/8	1/8	4	5	4	21,5					
SS 1/4	1/4	7	6	4	36					
SS 3/8	3/8	8	8	5	44					
SS 1/2	1/2	10	12	8	48					
SS 3/4	3/4	15	17	10	52					
SS 1	1"	18	23	10	55					

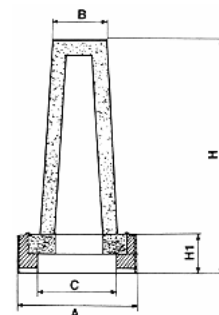

## SP SILENCIADOR DE PASTILLA



CODIGO	A	B	C	S	H	F	G	CH	CH1	Gr
SP 1/8	1/8	7	5	2	4					
SP 1/4	1/4	9	6	3	4					
SP 3/8	3/8	11	8	4	5					
SP 1/2	1/2	16	12	4	8					
SP 3/4	3/4	22	17	4	10					
SP 1	1"	28	23	4	10					

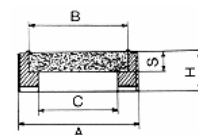

## SZ SILENCIADOR CON CUERPO MOLETEADO



CODIGO	A	B	C	F	H	F	G	CH	CH1	Gr
SZ M5	M5	14	15	4	9,5					
SZ 1/8	1/8	19	20	6	13,5					
SZ 1/4	1/4	24	25	8	15					
SZ 3/8	3/8	28	30	9	17					
SZ 1/2	1/2	34	36	10	19					

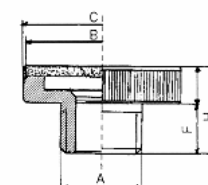

## SEF SILENCIADOR HEXAGONAL HEMBRA



CODIGO	A	F	B	H	E	F	G	CH	CH1	Gr
SEF M5	M5	4	3,5	7,5				8		
SEF 1/8	1/8	6	11	10,5				13		
SEF 1/4	1/4	6	14	11				16		
SEF 3/8	3/8	7,5	17	12				19		
SEF 1/2	1/2	8	22	13				24		

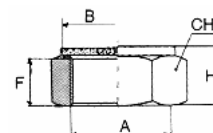

## SEX SILENCIADOR HEXAGONAL EN ACERO INOX.



CODIGO	A	F	H	D	E	F	G	CH	CH1	Gr
SEX M5	M5	6	25					13		
SEX 1/8	1/8	6	25					13		
SEX 1/8 F	1/8 F	-	-					-		
SEX 1/4	1/4	8	33					16		
SEX 3/8	3/8	9	40					19		
SEX 1/2	1/2	10	47					24		
SEX 3/4	3/4	10	56					30		
SEX 1"	1"	15	64					36		

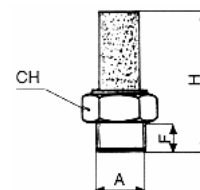

## ECO1 SILENCIADOR CENTRALIZADO ECOLOGICO

CODIGO	A	B	C	D	E	F	G	Gr
ECO 1								

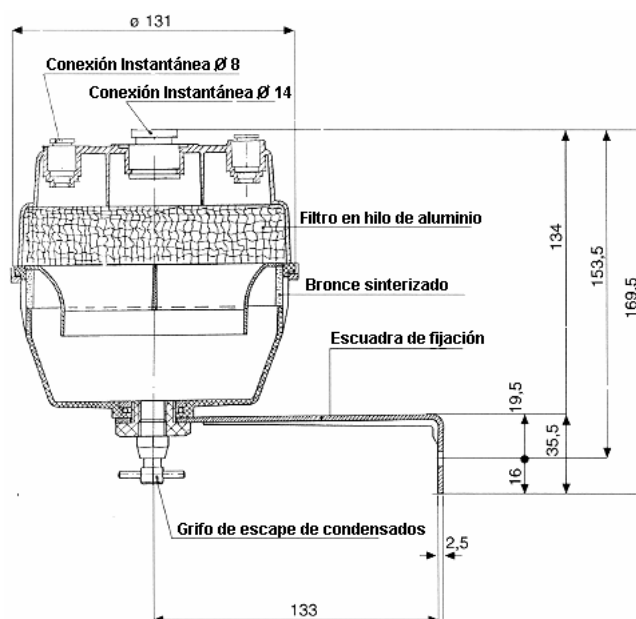

## ECO-S SILENCIADOR ECOLOGICO



CODIGO	A	Ø	H	D	E	F	G	CH	CH1	Gr
ECO-S 1/8	1/8	65	68							
ECO-S 1/4	1/4	65	68							
ECO-S 3/8	3/8	95	95							
ECO-S 1/2	1/2	95	95							
ECO-S 3/4	3/4	131	134							
ECO-S 1"	1"	131	134							

